

Features

20 A Power relays
1 NO + 1 NC (SPST-NO + SPST-NC)

65.31 Flange mount
Faston 250 connections

65.61 PCB mount

- AC coils & DC coils
- Cadmium Free option available

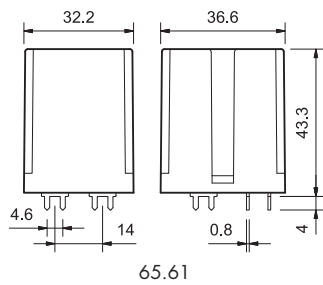

* With the $AgSnO_2$ material the maximum peak current is 120 A - 5 ms on NO contact.

FOR UL HORSEPOWER AND PILOT DUTY RATINGS
SEE "General technical information" page V

65.31



- 20 A rated contacts
- Flange mount/Faston 250 (6.3x0.8 mm) connection

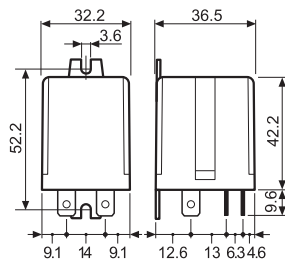
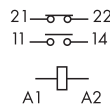

65.61



- 20 A rated contacts
- PCB mount - bifurcated terminals

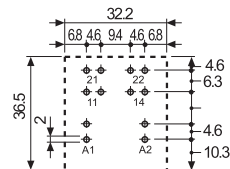
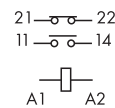

Copper side view

Contact specification		65.31	65.61
Contact configuration		1NO+1NC (SPST-NO+SPST-NC)	1NO+1NC (SPST-NO+SPST-NC)
Rated current/Maximum peak current	A	20/40*	20/40*
Rated voltage/Maximum switching voltage V AC		250/400	250/400
Rated load AC1	VA	5,000	5,000
Rated load AC15 (230 V AC)	VA	1,000	1,000
Single phase motor rating (230 V AC)	kW	1.1	1.1
Breaking capacity DC1: 30/110/220 V	A	20/0.8/0.5	20/0.8/0.5
Minimum switching load	mW (V/mA)	1,000 (10/10)	1,000 (10/10)
Standard contact material		AgCdO	AgCdO
Coil specification		65.31	65.61
Nominal voltage (U_N)	V AC (50/60 Hz)	6 - 12 - 24 - 48 - 60 - 110 - 120 - 230 - 240 - 400	6 - 12 - 24 - 48 - 60 - 110 - 120 - 230 - 240 - 400
	V DC	6 - 12 - 24 - 48 - 60 - 110 - 125 - 220	6 - 12 - 24 - 48 - 60 - 110 - 125 - 220
Rated power AC/DC	VA (50 Hz)/W	2.2/1.3	2.2/1.3
Operating range	AC	$(0.8 \dots 1.1)U_N$	$(0.8 \dots 1.1)U_N$
	DC	$(0.85 \dots 1.1)U_N$	$(0.85 \dots 1.1)U_N$
Holding voltage	AC/DC	$0.8 U_N / 0.6 U_N$	$0.8 U_N / 0.6 U_N$
Must drop-out voltage	AC/DC	$0.2 U_N / 0.1 U_N$	$0.2 U_N / 0.1 U_N$
Technical data		65.31	65.61
Mechanical life AC/DC	cycles	$10 \cdot 10^6 / 30 \cdot 10^6$	$10 \cdot 10^6 / 30 \cdot 10^6$
Electrical life at rated load AC1	cycles	$80 \cdot 10^3$	$80 \cdot 10^3$
Operate/release time	ms	10/12	10/12
Insulation between coil and contacts (1.2/50 μ s)	kV	4	4
Dielectric strength between open contacts	V AC	1,500	1,500
Ambient temperature range	$^{\circ}$ C	-40...+75	-40...+75
Environmental protection		RT I	RT I
Approvals (according to type)		CE, SB, PG, M, CULUS, VDE	CE, SB, PG, M, CULUS, VDE

Features

30 A Power relays
1 NO (SPST-NO)

65.31-0300 Flange mount
Faston 250 connections

65.61-0300 PCB mount

- ≥ 3 mm contact gap
- AC coils & DC coils
- Cadmium Free option available

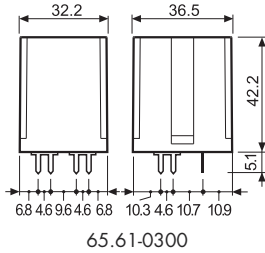

* Distance between contacts ≥ 3 mm (EN 60335-1).

** With the AgSnO_2 material the maximum peak current is 120 A - 5 ms on NO contact.

FOR UL HORSEPOWER AND PILOT DUTY RATINGS
SEE "General technical information" page V

65.31-0300



- 30 A rated contacts
- Flange mount/Faston 250 (6.3x0.8 mm) connection

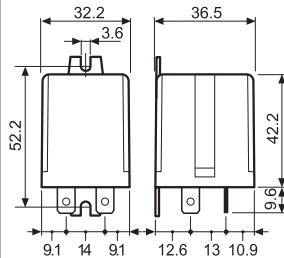
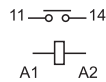

65.61-0300



- 30 A rated contacts
- PCB mount - bifurcated terminals

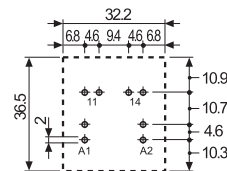
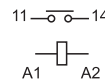

Copper side view

Contact specification

Contact configuration	1 NO (SPST-NO), ≥ 3 mm*	1 NO (SPST-NO), ≥ 3 mm*
Rated current/Maximum peak current	A	30/50**
Rated voltage/Maximum switching voltage	V AC	250/400
Rated load AC1	VA	7,500
Rated load AC15 (230 V AC)	VA	1,250
Single phase motor rating (230 V AC)	kW	1.5
Breaking capacity DC1: 30/110/220 V	A	30/1.1/0.7
Minimum switching load	mW (V/mA)	1,000 (10/10)
Standard contact material	AgCdO	AgCdO

Coil specification

Nominal voltage (U_N)	V AC (50/60 Hz)	6 - 12 - 24 - 48 - 60 - 110 - 120 - 230 - 240 - 400
	V DC	6 - 12 - 24 - 48 - 60 - 110 - 125 - 220
Rated power AC/DC	VA (50 Hz)/W	2.2/1.3
Operating range	AC	$(0.8 \dots 1.1) U_N$
	DC	$(0.85 \dots 1.1) U_N$
Holding voltage	AC/DC	$0.8 U_N / 0.6 U_N$
Must drop-out voltage	AC/DC	$0.2 U_N / 0.1 U_N$

Technical data

Mechanical life AC/DC	cycles	$10 \cdot 10^6 / 30 \cdot 10^6$
Electrical life at rated load AC1	cycles	$50 \cdot 10^3$
Operate/release time	ms	15/4
Insulation between coil and contacts (1.2/50 μ s)	kV	4
Dielectric strength between open contacts	V AC	2,500
Ambient temperature range	$^{\circ}$ C	-40...+75
Environmental protection		RT I

Approvals (according to type)



Ordering information

Example: 65 series power relay, PCB with bifurcated terminals, 1 NO + 1 NC (SPST-NO + SPST-NC) contact, 12 V DC coil.

	6	5	.	6	1	.	9	.	0	1	2	.	A	B	C	D
Series	65															
Type	6															
	3 = Faston 250 (6.3x0.8 mm) with rear flange mount															
	6 = PCB with bifurcated terminals															
No. of poles	1															
	1 = 1 NO + 1 NC (SPST-NO + SPST-NC)															
Coil version	9															
	8 = AC (50/60 Hz)															
	9 = DC															
Coil voltage																
	See coil specifications															

A: Contact material	0 = Standard AgCdO	D: Special versions	0 = Standard
	4 = AgSnO ₂		9 = Type 65.31 without rear flange mount
B: Contact circuit	0 = 1 NO + 1 NC (SPST-NO + SPST-NC)	C: Options	0 = None
	3 = NO (≥ 3 mm contact gap)		

Selecting features and options: only combinations in the same row are possible.
Preferred selections for best availability are shown in **bold**.

Type	Coil version	A	B	C	D
65.31	AC-DC	0 - 4	0 - 3	0	0 - 9
65.61	AC-DC	0 - 4	0 - 3	0	0

Technical data

Insulation according to EN 61810-1		1 NO + 1 NC		1 NO	
Nominal voltage supply system	V AC	230/400		230/400	
Rated insulation voltage	V AC	250	400	250	400
Pollution degree		3	2	3	2
Insulation between coil and contact set					
Type of insulation		Basic		Basic	
Overtoltage category		III		III	
Rated impulse voltage	kV (1.2/50 μs)	4		4	
Dielectric strength	V AC	2,500		2,500	
Insulation between open contacts					
Type of disconnection		Micro-disconnection		Full-disconnection	
Overtoltage category		—		III	
Rated impulse voltage	kV (1.2/50 μs)	—		4	
Dielectric strength	V AC/kV (1.2/50 μs)	1,500/2		2,500/4	
Conducted disturbance immunity					
Burst (5...50)ns, 5 kHz, on A1 - A2		EN 61000-4-4		level 4 (4 kV)	
Surge (1.2/50 μs) on A1 - A2 (differential mode)		EN 61000-4-5		level 4 (4 kV)	
Other data					
Bounce time: NO/NC	ms	5/6 (1 normally open + 1 normally closed)		7/— (normally open)	
Vibration resistance (10...150)Hz: NO/NC	g	20/13			
Shock resistance	g	20			
Power lost to the environment	without contact current	W	1.3		
	with rated current	W	2.1 (65.31, 65.61)		3.1 (65.31/.61.0300)
Recommended distance between relays mounted on PCB	mm	≥ 5			

Contact specification

F 65 - Electrical life (AC) v contact current

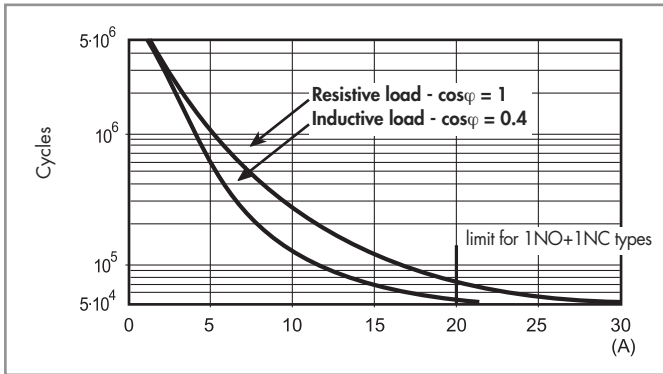

H 65 - Maximum DC1 breaking capacity

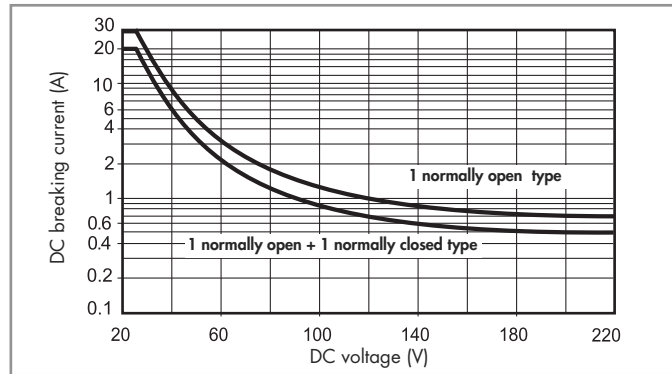

- When switching a resistive load (DC1) having voltage and current values under the curve, an electrical life of $\geq 80 \cdot 10^3$ can be expected.
- In the case of DC13 loads, the connection of a diode in parallel with the load will permit a similar electrical life as for a DC1 load.
Note: the release time for the load will be increased.

Coil specifications

DC coil data

Nominal voltage U_N V	Coil code	Operating range		Resistance R Ω	Rated coil consumption I at U_N mA
		U_{min} V	U_{max} V		
6	9.006	5.1	6.6	28	214
12	9.012	10.2	13.2	110	109
24	9.024	20.4	26.4	445	54
48	9.048	40.8	52.8	1,770	27.1
60	9.060	51	66	2,760	21.7
110	9.110	93.5	121	9,420	11.7
125	9.125	106	138	12,000	10.4
220	9.220	187	242	37,300	5.8

AC coil data

Nominal voltage U_N V	Coil code	Operating range		Resistance R Ω	Rated coil consumption I at U_N (50Hz) mA
		U_{min} V	U_{max} V		
6	8.006	4.8	6.6	4.6	367
12	8.012	9.6	13.2	19	183
24	8.024	19.2	26.4	74	90
48	8.048	38.4	52.8	290	47
60	8.060	48	66	450	37
110	8.110	88	121	1,600	20
120	8.120	96	132	1,940	18.6
230	8.230	184	253	7,250	10.5
240	8.240	192	264	8,500	9.2
400	8.400	320	440	19,800	6

R 65 - DC coil operating range v ambient temperature

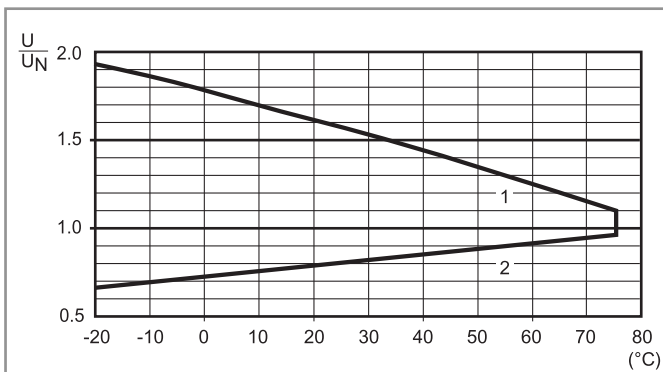

- 1 - Max. permitted coil voltage.
- 2 - Min. pick-up voltage with coil at ambient temperature.

R 65 - AC coil operating range v ambient temperature

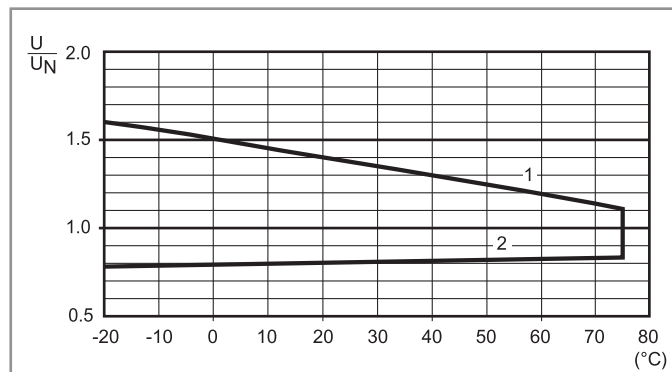

- 1 - Max. permitted coil voltage.
- 2 - Min. pick-up voltage with coil at ambient temperature.

Accessories



Top flange mount for types 65.31..xxxx.xxx9

065.05

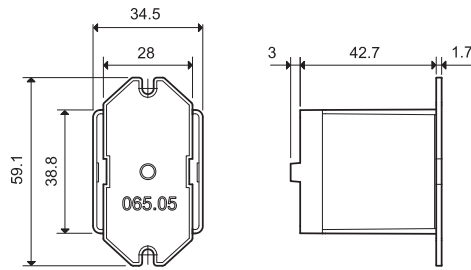

065.05

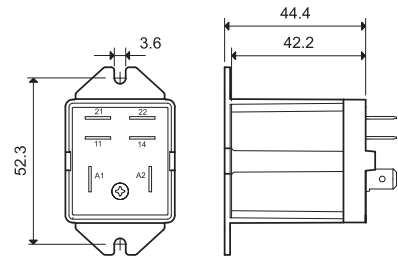

065.05 with relay



Top 35 mm rail (EN 60715) mount for types 65.31..xxxx.xxx9

065.07

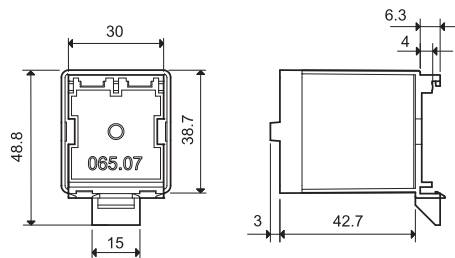

065.07

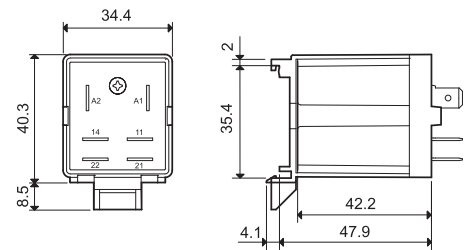

065.07 with relay



Rear 35 mm rail (EN 60715) mount for types 65.31..xxxx.xxx9

065.08

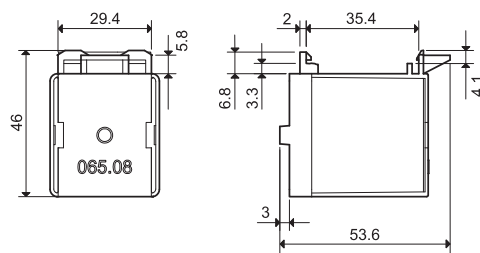

065.08

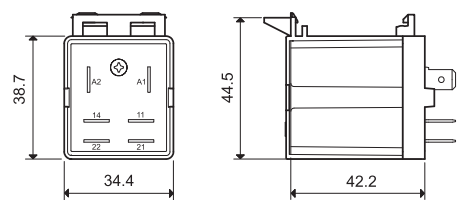

065.08 with relay